



# Commander myQ

Your Home. On Command



**DOOR TYPES:** residential sectional doors **DOOR SIZE:** doors up to 20m<sup>2</sup>

## Key Benefits

- 

**Compliant to Australian and New Zealand Standard AS/NZS 60335-2-95** 
- 

**Security+2.0**  
Transmitters communicate on multiple frequencies with encrypted rolling code. This ensures the strongest frequency is selected every time, virtually eliminating interference while providing the highest level of security.
- 

**MyQ Technology**  
Monitor, control and receive alert notifications on your Commander MyQ away from home. Through the use of either your Smart phone, Tablet or Computer you can monitor and control the garage door remotely. Anytime scheduling to close your garage door. Your Home, On Command.
- 

**Up to 75% less energy\***  
Advanced technology uses less than 1 watt of power whilst in standby mode, meeting the world's toughest energy standards.
- 

**Quiet and Powerful Motor**  
The powerful and fast DC motor is quiet and built to last with the strength to open any branded domestic door.
- 

**Improved Transmitter Range**  
Tested against other products, these transmitters have up to 18% better range which means you can start opening your garage door sooner.
- 

**Soft Start / Stop Function**  
Designed to ensure smooth and quiet door operation.
- 

**7 Year Warranty**  
Backed by a 7 year / 15,000 cycle warranty\*\* we stand behind our products with an after sales support team that we believe are the best in the industry.
- 

**Standard Merlin Safety Features**

  - 

**Premium Automatic Safety Reverse**  
With its automatic safety function your garage door will stop and reverse automatically if obstructed going down or stop going up.
  - 

**Automatic Force Sensing**  
Equipped with automatic force sensing, with each operation the garage door opener monitors and adjusts the force needed to open your garage door.
  - 

**Manual Release**  
In case of power failure you can simply activate the manual release to open your garage door.

\*when compared to other available products \*\* conditions apply

## Kit Contents

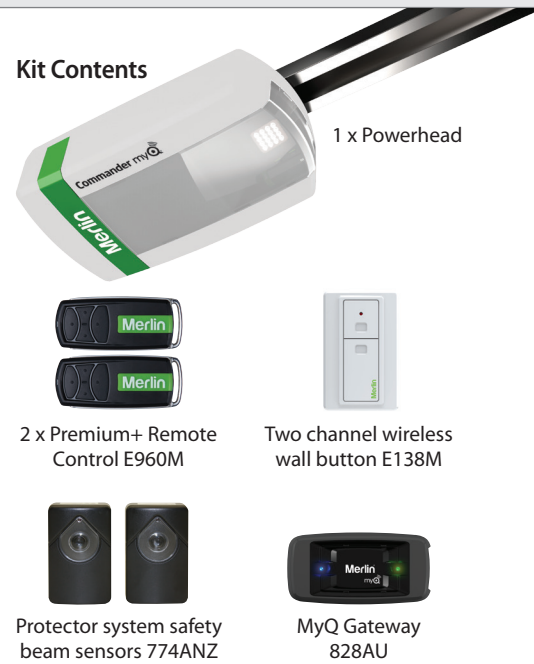

## SPECIFICATIONS

- 24V DC motor with thermal overload protection
- Input voltage: 240V AC
- Rated door area up to 20m<sup>2</sup>
- Max door weight: up to 130kg
- Max peak pulling force: 1000 N
- C-rail with belt drive
- 433.92, 433.30, 434.54 MHz AM radio with Chamberlain Security + 2.0 rolling code technology
- Up to 64 memory registers
- Courtesy light: LED
- Min headroom required: 30mm
- MyQ Technology

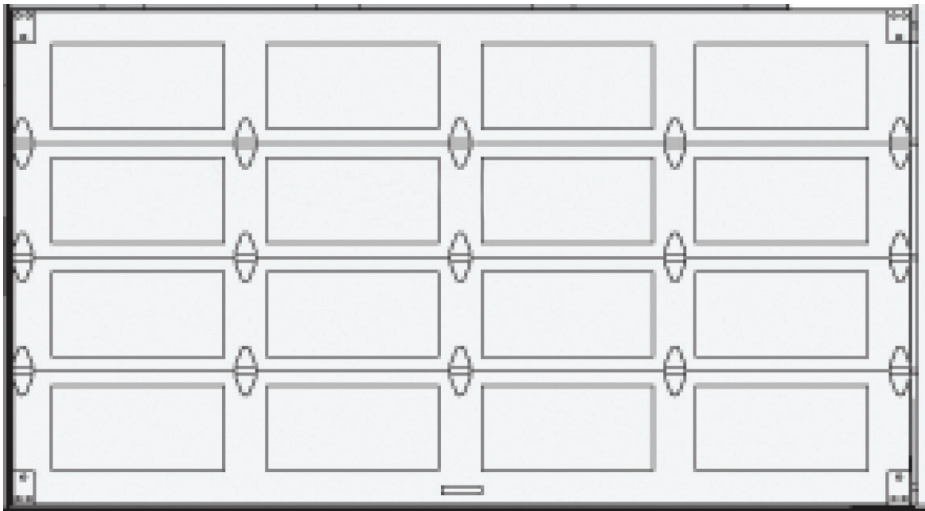

### DOOR SPECIFICATIONS

- Maximum lifting under spring tension = 20kg
- Suitable for steel and timber spring balanced doors

### DOOR OPENING AND CLOSING TIMES

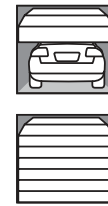

18 seconds

21 seconds

(based on a 2.2m high door)

Door height: 3.5m, Door width: 5.7m, Total door area 20m<sup>2</sup>  
Single dwelling, max door weight: up to 130kg

### TYPICAL INSTALLATION - SECTIONAL DOOR

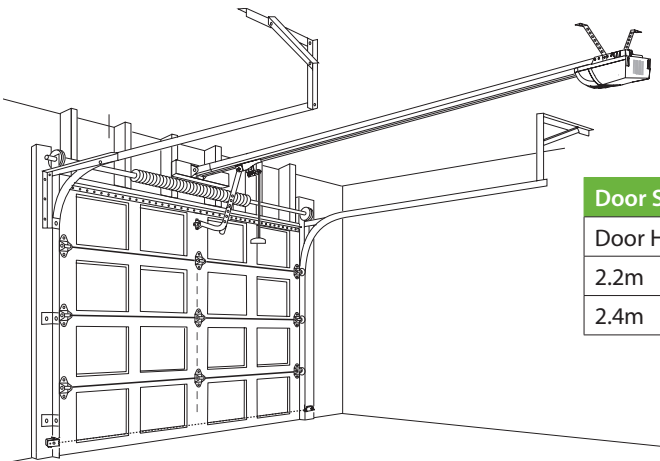

#### Door Specifications

Door Height	Fixing Point	Alt. Fixing Point
2.2m	2840mm	2950mm
2.4m	3040mm	3150mm

### OPTIONAL ACCESSORIES

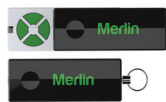

Four channel  
key ring  
mini-transmitters  
E950M



Wall or visor  
mounted three  
channel transmitter  
E943M



Wall or visor  
mounted single  
channel transmitter  
E940M



3 channel mini  
transmitter  
E945M



Wireless keypad  
E840M

## CHAMBERLAIN®

The World's Largest Manufacturer of Garage Door Openers

**Australia** Phone: 1800 638 234 Fax: 1800 888 121 Web: [gomerlin.com.au](http://gomerlin.com.au)

**New Zealand** Phone: 0800 653 667 Fax: 0800 653 663 Web: [gomerlin.co.nz](http://gomerlin.co.nz)

™ Trademark of The Chamberlain Group, Inc. ® Registered Trademark of the Chamberlain Group, Inc.  
© 2016 The Chamberlain Group, Inc.

